

Universal Payment Stand /PS-1010

All Steel

Adjustable Structure

Flexible Movement



FEATURES

Universal for Various Payment Terminals

Every clip can be adjusted by loosening the screws under the plate.
Easy to use: install your payment terminal and tighten the clips around it.
Applicable to payment terminals of different sizes from 70-108.5mm wide.



Flexible Movement

The upper pole can be rotated 180° from customer side to cashier side.
Tilttable plate offers ideal viewing angle and adapts to different operation habits

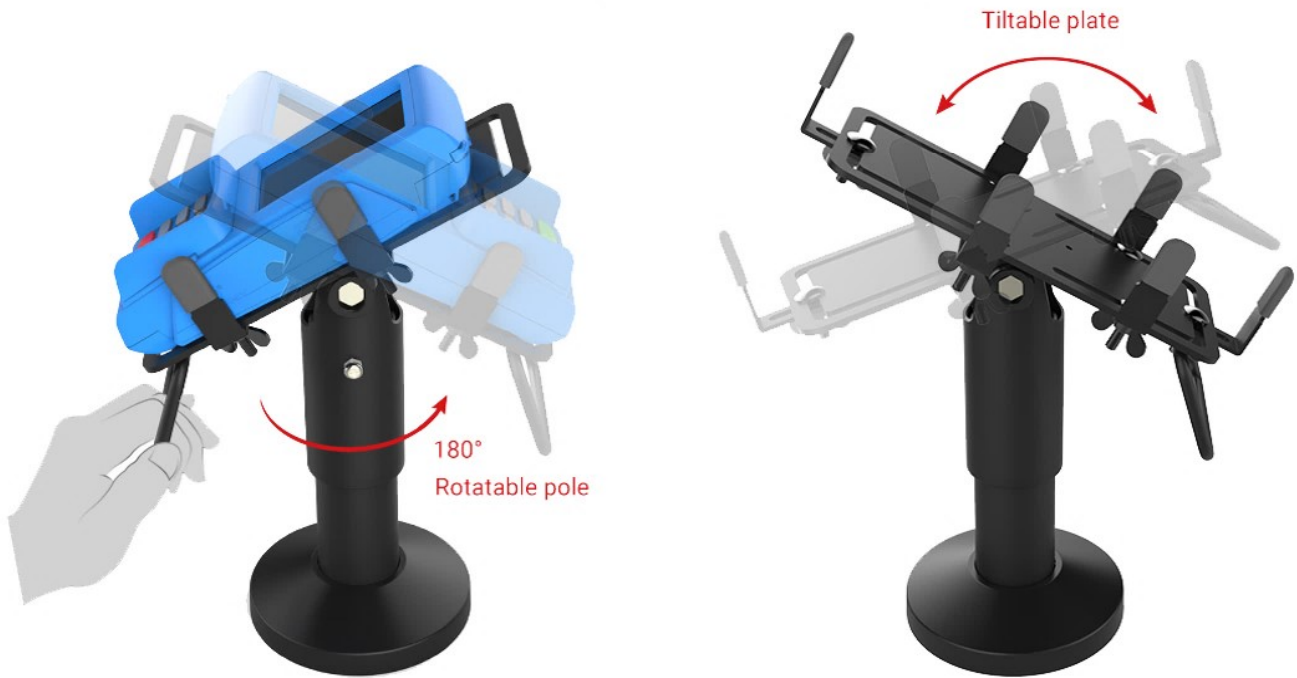

Cost Saving

Customers can upgrade and replace their payment terminals at any time without worrying about additional installation costs.



Steel Structure & Detail Design

Made of thick heavy-duty steel, the stand keep stable and durable even under frequent use. Many details have been added: detachable clips, flange cover, routing hole, etc. Customizable colors.



Please note that the PS-1010 has been tested with the EFTPOS terminals listed below, but should be suitable for use with any terminal that is 70mm-108.5mm in width, including terminals from Banks, Tyro, Smartpay and all other payment terminal providers.

ingenico iPP 350
ingenico iPP 320
ingenico iPP 315
ingenico iCT 250
ingenico iCT 220/220CL
ingenico iWL Series
ingenico iWE280

Compatible payment terminals

ingenico APOS A8	Verifone T650c	PAX D210
ingenico Move/2500	Verifone V400c	PAX S300
ingenico Desk/5000	Verifone V200c	PAX SP30
ingenico Desk/3000	Verifone P400	
ingenico Desk/1500	Verifone P200	
ingenico Lane/3000	Verifone VX820	
	Verifone VX805	
	Verifone VX680	